

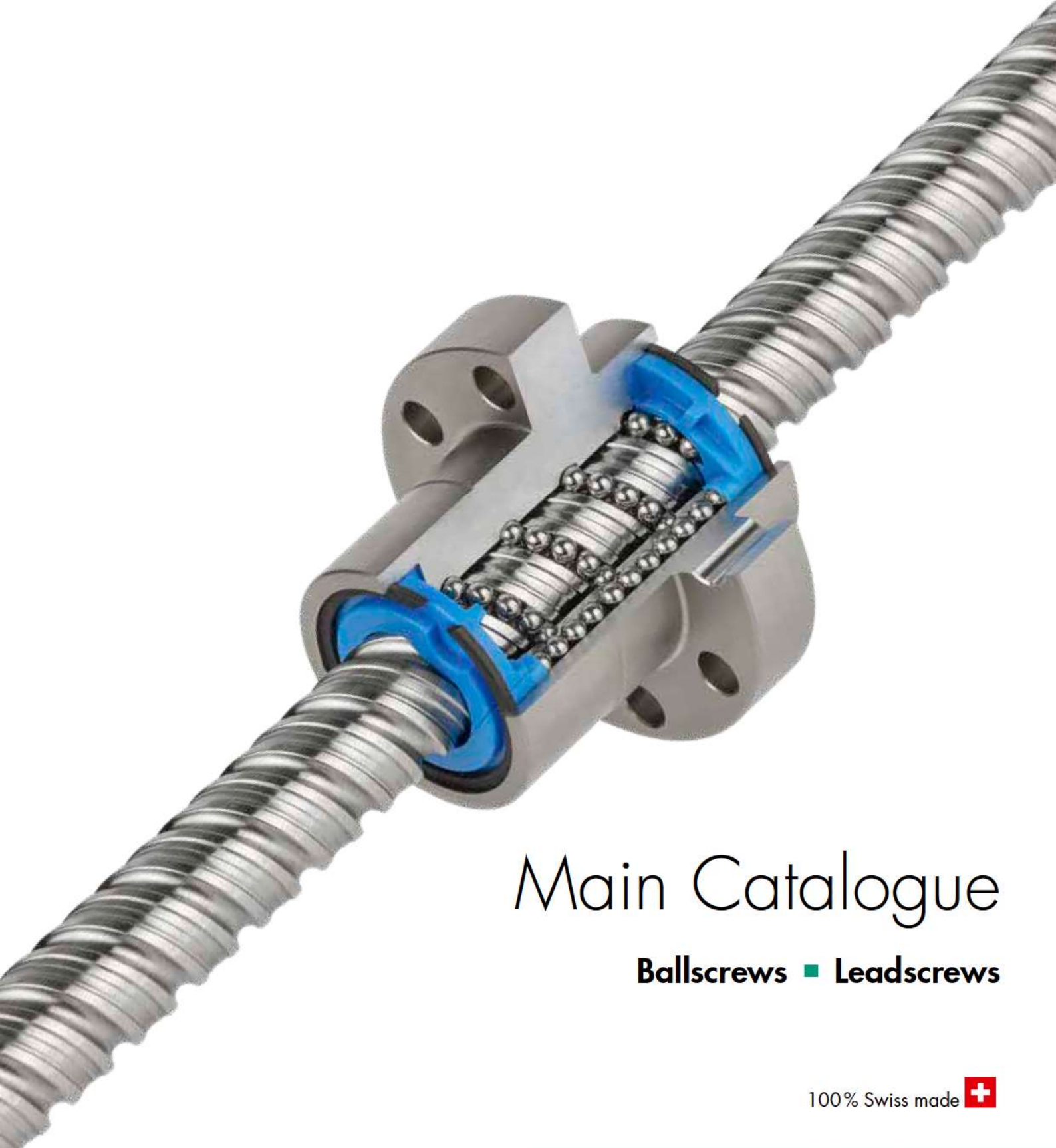

**Eichenberger** Gewinde



# Main Catalogue

**Ballscrews ■ Leadscrews**

100% Swiss made 



**Design features**

Eichenberger Easy light leadscrows set new benchmarks for net weight and smooth running properties. Thanks to the rolled aluminium screw and the associated nut made of high-performance technopolymer, the screw unit is a real lightweight. The screw's robust sliding coating (hard-anodised) makes the screw unit very smooth. With correct lubrication, efficiency of more than 0.8 can be achieved – an excellent figure for a leadcrew!

Thanks to the special thread geometry, the screw unit is also relatively impervious to dirt and tilting torque.

**Materials**

- **Screw**
- standard:
  - aluminium, hard-anodised
- on request:
  - other materials and coatings

**Nut**

- standard:
  - EX100 white
- on request:
  - other materials

**Nut type (shape)**



**Easy standard flange nut**

- **Type EFM**
- flange nut type A following DIN 69051
- not preloaded
- wearresistant technopolymer EX100 white

If required, any application-specific nut shapes can be manufactured, for large series also from injection moulding. Contact us with your revolutionary idea – we'll provide YOUR tailor-made light-leadcrew!

**Operational temperatures**

- EX100 –40 to +60 °C

**Lead accuracy**

- standard:
  - $G9 \pm \leq 0.1$  mm/300 mm (in accordance with DIN 69051)
- on request:
  - other lead accuracies

**Order system – Easy light leadscrows**

**Example for complete Easy light leadscrows** \_\_\_\_\_ **EGS 20 x 80 EFM RH 6.50 G9 E M**

**Type of thread drive** \_\_\_\_\_

EGS = Easy light leadcrew

**Nominal size (d<sub>g</sub> × p) [mm]** \_\_\_\_\_

for nut only

**Nut type** \_\_\_\_\_

EFM = Easy standard flange nut (EX100 white) <sup>1)</sup>

MSX = special design according to drawing

**Right-hand / left-hand thread** \_\_\_\_\_

RH = right-hand thread (standard)

LH = left-hand thread (availability see dimensional chart)

**Lead screw overall length [mm]** \_\_\_\_\_

standard material quality: aluminium, hard-anodised <sup>1)</sup>

for screw only

**Lead accuracy (class)** \_\_\_\_\_

G9 =  $\leq 0.1$  mm/300 mm (standard)

GX = lead accuracy upon specification

for screw only

**Screw end machining** \_\_\_\_\_

O = no end machining (cut by grinding)

E = end machining according to drawing

for screw only

**Assembly** \_\_\_\_\_

G = screw and nut separate (standard)

M = screw and nut assembled according to drawing/specified orientation

<sup>1)</sup> other materials on request

**Example for screw only** \_\_\_\_\_

**EGS 20 x 80 RH 6.50 G9 O G**

**Example for nut only** \_\_\_\_\_

**EGS 20 x 80 EFM RH G**

**Efficiency**

The efficiency  $\eta$  depends on the helix angle and reaches impressive values over 0.8  
 > also see diagram, page 44

**Production / Handling / Lubrication**

> see Speedy, page 42

**Application examples for Eichenberger leadscrows**

> see Speedy, page 43

**Design fundamentals for leadscrows**

> see Speedy, pages 44–45



# Easy light leadscrews

## ø20

Standard flange nut

EFM

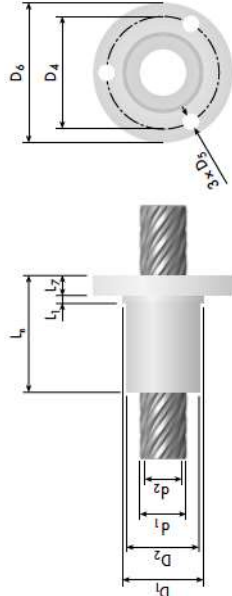

Nut type (details > page 58)



Flange nut, not preloaded  
Type EFM

Nominal size	Right-hand/ left-hand thread	Dimensions [mm]						Nut		Lead rates						Nominal size				
$d_{\text{sp}}$ [mm]		$d_1$	$d_2$	$d_3$	$d_4$	$d_6$	$D_1$	$D_2$	$D_3$	$D_4$	$D_5$	$D_6$	$L_1$	$L_2$	$L_3$	$L_4$	$L_5$	$L_6$	$C_{\text{sp}}$ [N]	$d_{\text{sp}}$ [mm]
20 × 80	RH / LH	20.0	15.2	8	36	35.5	47	6.2	59	46	5	8							4000	20 × 80

> CAD data > www.gewinde.ch

### Legend

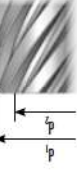

$d_s$  = nominal screw diameter [mm]  
 $d_o$  = outer screw diameter [mm]  
 $d_c$  = core diameter [mm]

$p$  = pitch [mm]  
 $g$  = number of threads [-]  
Special designs available on request

### Design fundamentals for leadscrews

> see Speedy, pages 44–45

## Application examples

Thanks to their low weight, excellent smooth running properties and robust thread profile, Eichenberger Easy light leadscrews are suitable for numerous applications including:

- Drives for doors, gates and windows
- Handling technology
- Graphics equipment and devices
- Construction industry
- Air-conditioning technology (valve/slide drives)
- Textile machines
- Food and packaging industry
- Electric cylinders (actuators)
- etc.

Easy light leadscrews are preferred for increased demand from major temperature fluctuation based on climate, impact on environmental conditions such as pollution, limited lubrication options, tilting torque.

Eichenberger Easy light leadscrews always offer great value for money.

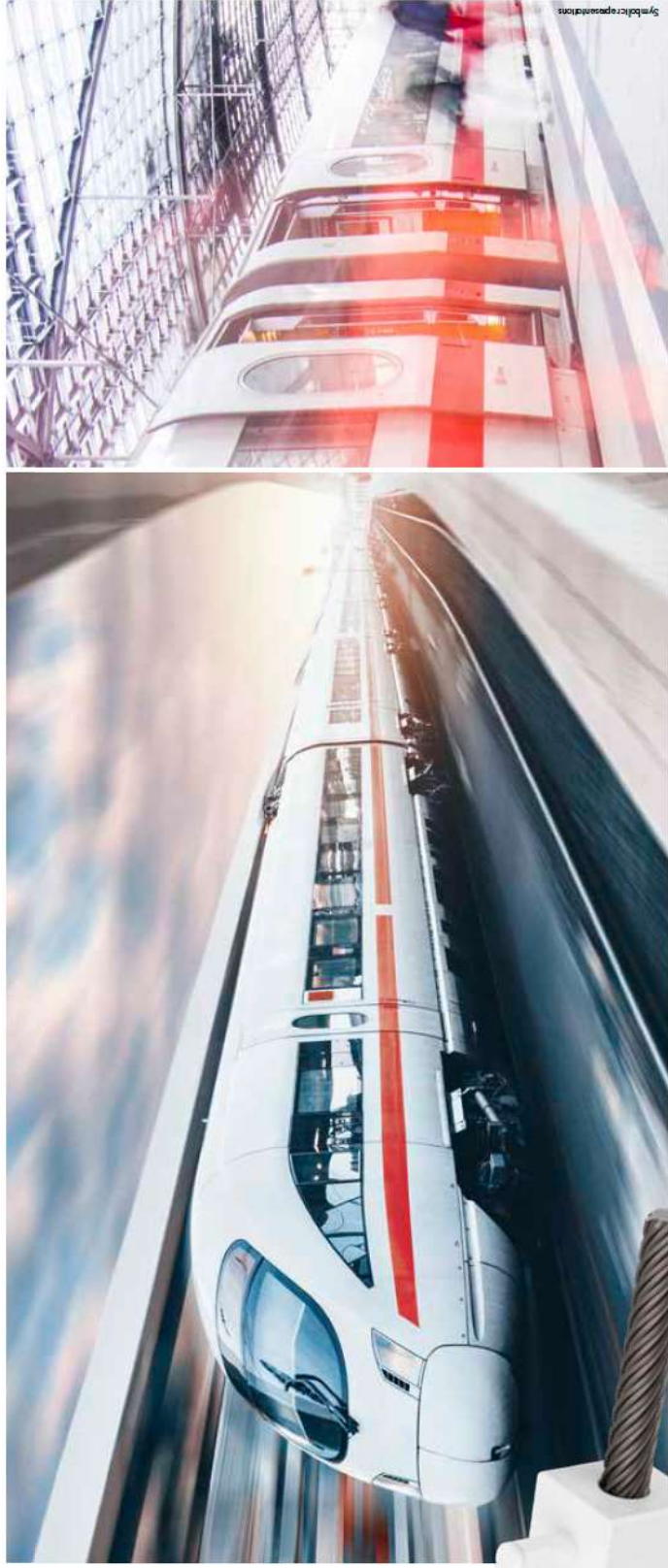

Easy door drives in train carriages of high speed trains withstand the harshest weather conditions and maximum physical forces