

RAIL "CEP"

- Anodized aluminum section standard (alloy 6005a)
- Length profile upon request (Maximum 5500 mm)
- Drilling upon request
- Sliders are supplied factory fitted with a slight pre-load
- Plate different to standard upon request
- Rails are supplied unfilled as standard
- Load ratings are per carrier and can be increased accordingly

Drilling plate details

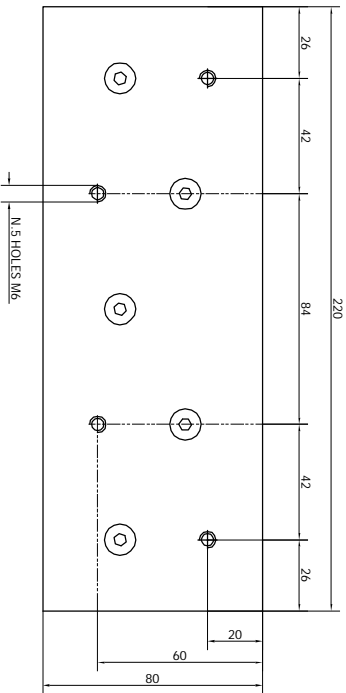

Aluminum slider with 5 bearings
(Max. Load 70 KG.)

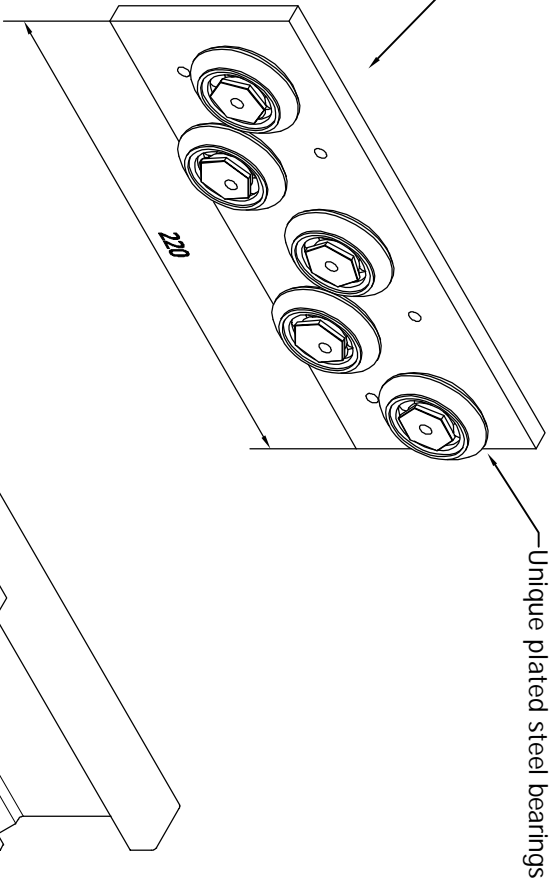

Unique plated steel bearings

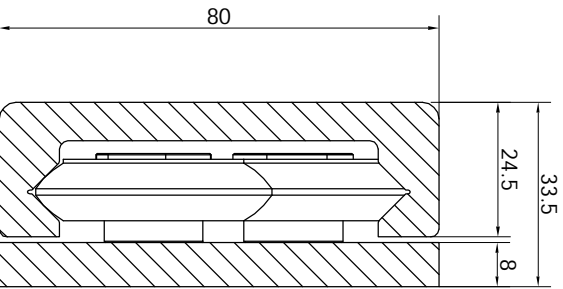

SECTION (Scale 2:1)

Anodized aluminium profile
Lengths & Drilling upon request Maximum 5500 mm
Drilling upon request

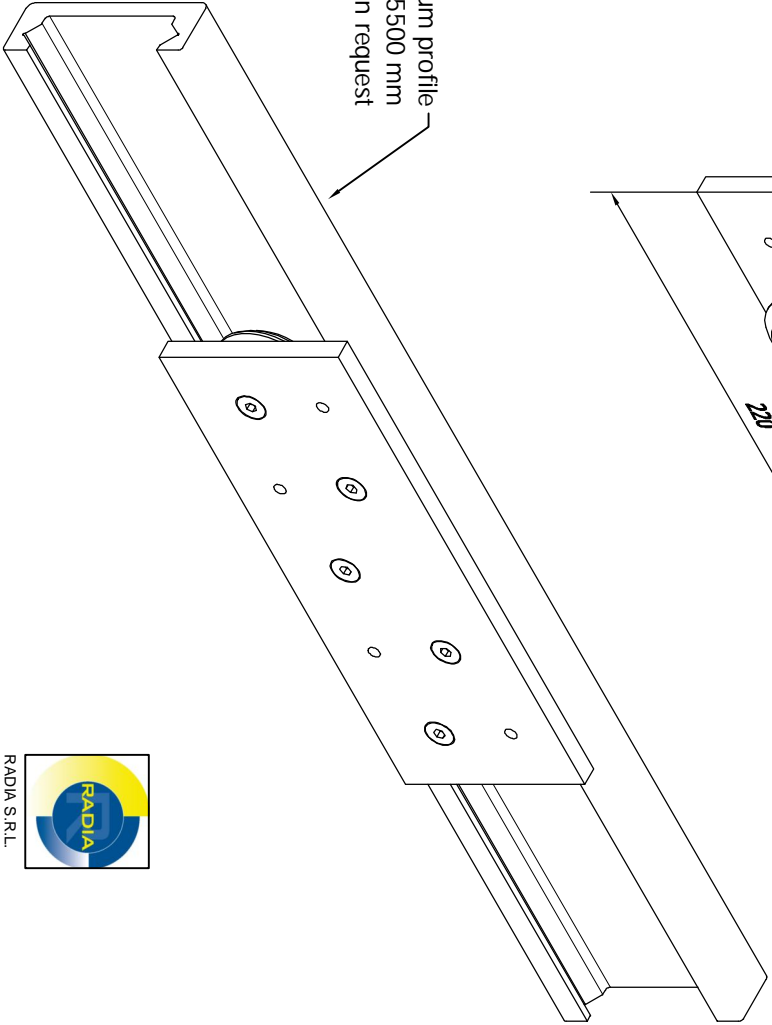

RADIA S.R.L.
Via Marconi 65/A - 10040 Pibbesi, Tonnesse - IT -
Tel. +39 011 9936019 Fax. +39 011 9936021
Inforadia@radiamotion.com
www.radiamotion.com